

Copyright. All information furnished within this document, electronic file or design correspondence is the property of Den Hartog industries, Inc. and shall not be used, disclosed to others or copied without the expressed written consent of Den Hartog Industries, Inc.

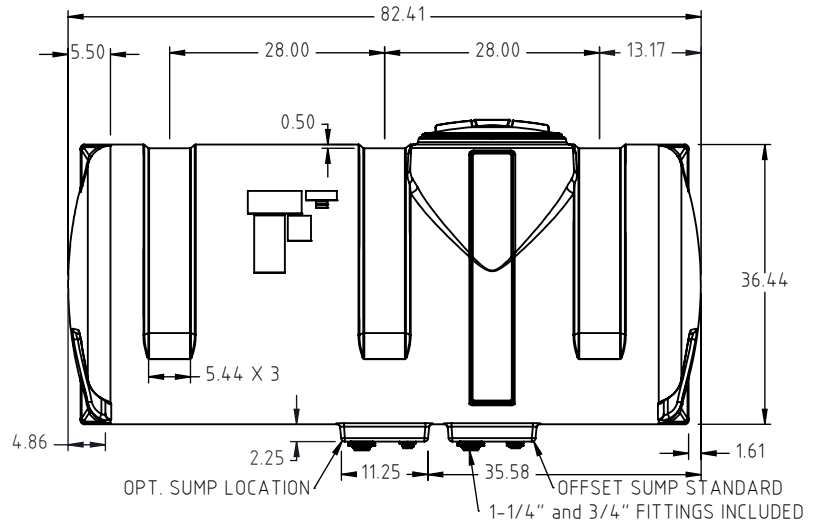

DRAWN / DATE ADH 9/6/2023	MATERIAL: POLYETHYLENE
APPRD. / DATE BES 5/1/2024	
SHOT WEIGHT: 163.00 LBS	NOTES: NOMINAL WALL THICKNESS: 0.310"
SHIPPING WEIGHT: 165.00 LBS	
FINISH:	

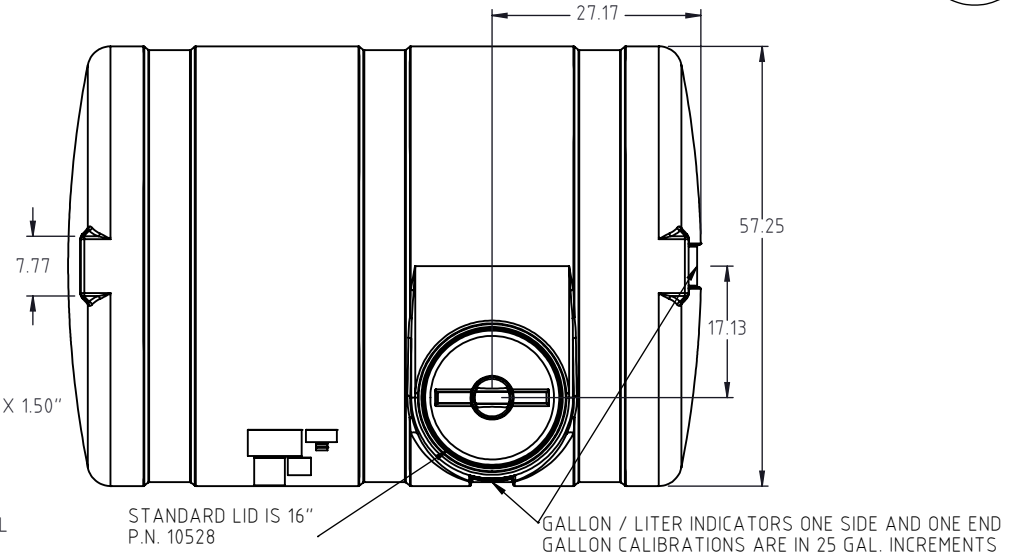
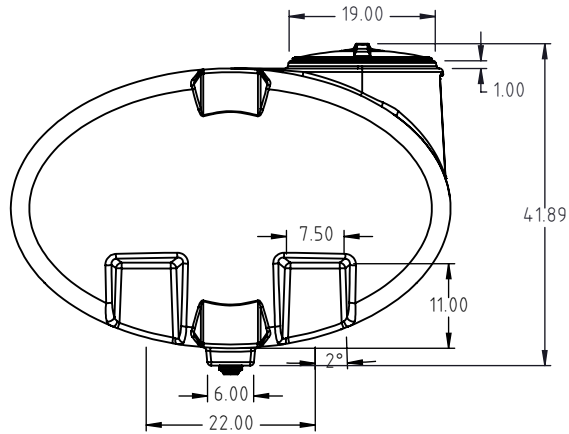
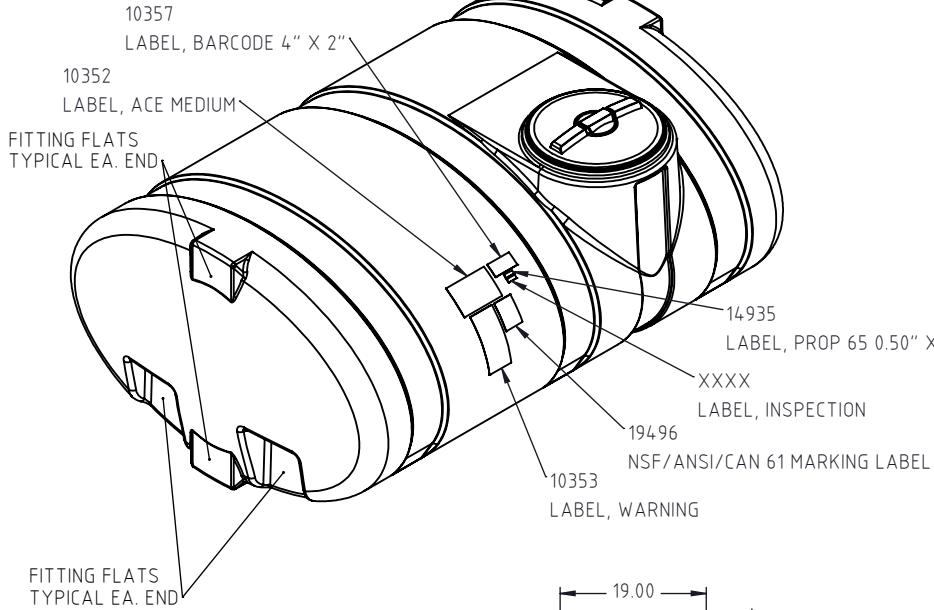

Den Hartog INDUSTRIES, INC.

Ace Roto-Mold • Injection Molding • Blow Molding • Sowjoy
4010 HOSPERS DRIVE S. BOX 425, HOSPERS, IOWA 51238-0425

REV.	DESCRIPTION	BY	DATE	CCN
ALL DIMENSIONS ARE IN DECIMAL INCHES TOLERANCES UNLESS OTHERWISE SPECIFIED				
POLYETHYLENE		THIRD ANGLE PROJECTION ANSI 14.5M		
METAL DECIMAL ± .125" FRACTION ± 1/4" ANGLE ± 1°				
±1% @ 68°F				

DESCRIPTION EO, ELLIPTICAL OFFSET LID 500 GAL TANK		PART NO. E00500-57		SHEET 1 OF 1
SCALE N.S.				