

NOTE	DESCRIPTION	NAME	DATE
A	HONEYCOMB PATTERN ADDED	GS	4/15/2008
B	PARKER LOGO, FLASH COMP, GATE CATCHER & BOTTOM ROCK CORRECTION ADDED	GS	4/30/2008
C	PARKER LOGO REMOVED, GC LOGO ADDED	GS	4/30/2008
D	PARTING LINE, FLASH COMP MOVED AT 45°, BOTTOM ROCK LOCATION MODIFIED, HANDLE SHAPE MODIFIED TO REMOVE UNDERCUTS, RADIUS AROUND HANDLE INCREASED, HONEYCOMB ENGRAVING DEPTH WAS 0.034", OVERALL SIZES SCALED TO ADJUST VOLUME	GS	5/8/2008

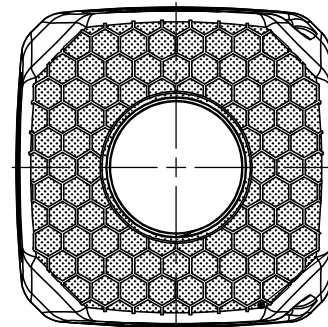

CUSTOM ETCH # 020 (0.004" DP)  
 ETCHING (PLEASE CONFIRM)

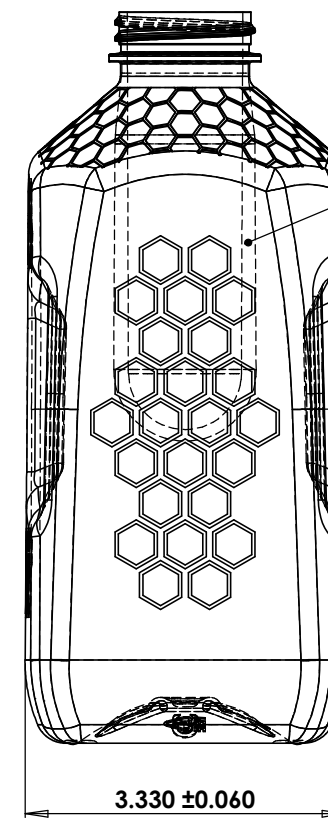
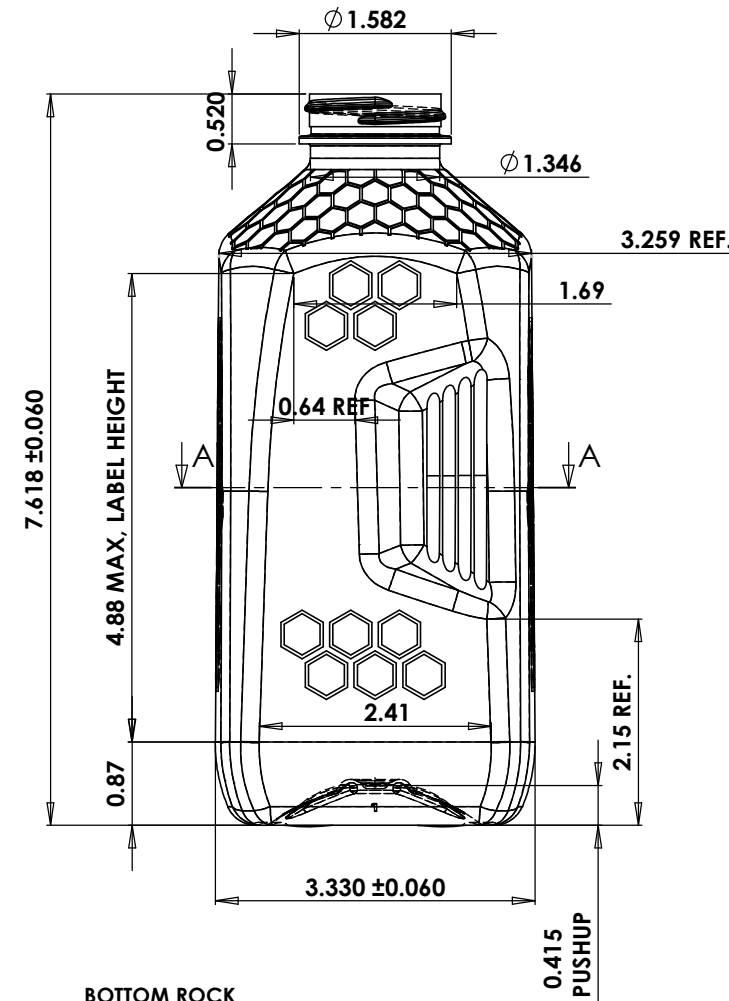
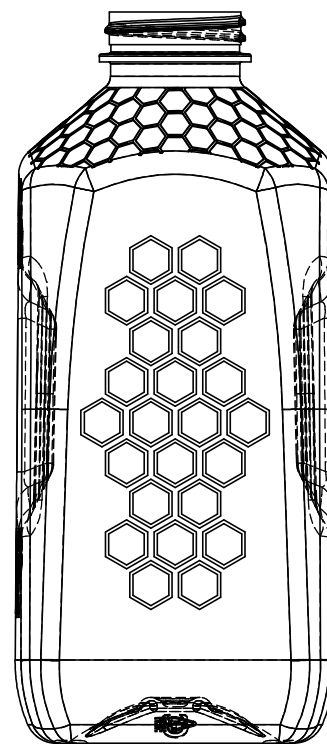

38MM SP400 PREFORM  
 55gr. DWG# P-1603

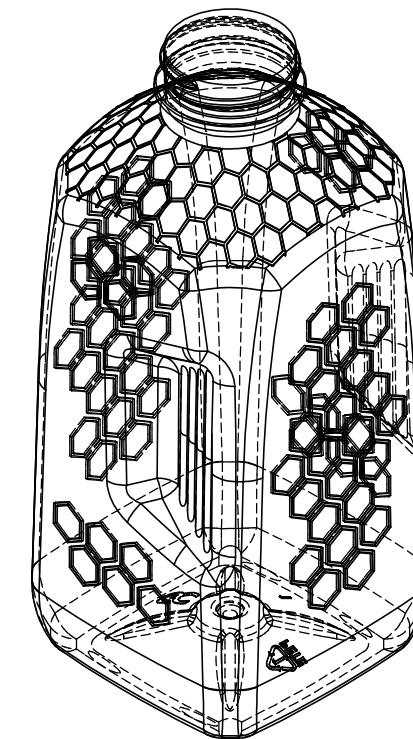

BOTTOM ROCK  
 4 PLCS.  
 0.015 HIGH

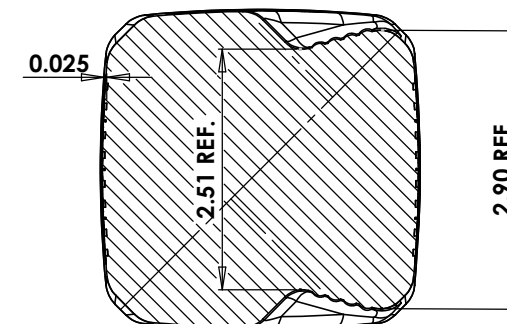
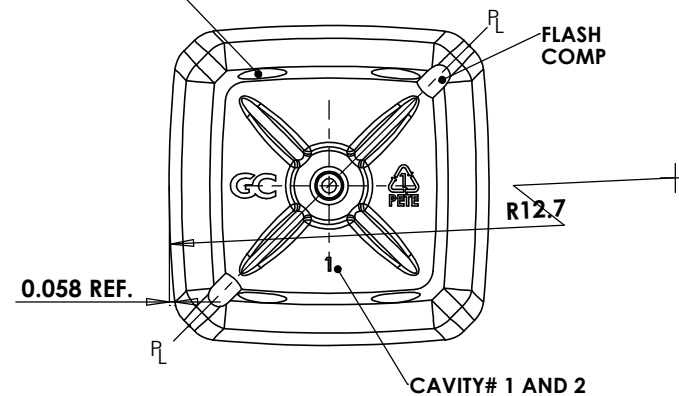

SECTION A-A

PREFORM STRETCH RATIOS:  
 LINEAR- 1.69:1  
 P/L & F TO B- 2.51:1  
 DIA- 3.10:1

PART DRAWING TO BE APPROVED  
 PRIOR TO MOULD PRODUCTION  
 APPROVED BY: \_\_\_\_\_  
 DATE: \_\_\_\_\_

BOTTLE OVERFLOW CAPACITY			PART WEIGHT	SHEET SIZE
1000ml ±15ml			55 gr	C
MATERIAL	APPROVALS	DATE		
PETE	GS	03/07/08		
NECK FINISH	CHECKED	DATE		
38MM SP400	RS	03/07/08		
	ISSUED	DATE		
	GS	03/07/08		

**PARKER PLASTICS INC.**

**3 LB GAMBER HONEYCOMB**

This drawing subject to standard industry tolerances. (S.P.I.)

JOB NO.	11486-40
CUSTOMER NO.	-
SCALE	1:1
SHEET	1 OF 1

DO NOT SCALE DRAWING